



# SB2C-4 Helldiver landing flaps

eduard

1/48 scale detail set for MONOGRAM-REVELL-ACCURATE MINIATURES kit sada detailů pro model 1/48

48 519

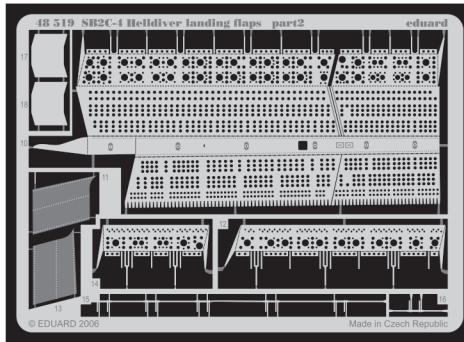
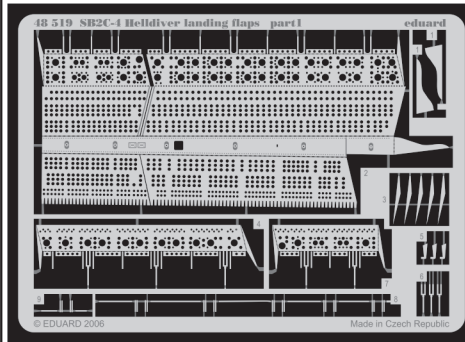

- APPLY EXPRESS MASK AND PAINT BEFORE GLUING  
POUŽIT EXPRESS MASK NABARVIT PŘED SLEPENÍM
- SYMMETRICAL ASSEMBLY  
SYMETRICKÁ MONTÁŽ
- REMOVE  
ODSTRANIT
- GRIND  
OBROUSIT
- DRILL HOLE  
VRTAT OTVOR
- BEND  
OHNOUT
- OPTION  
VOLBA
- REPLACE  
NAHRADIT

ORIGINAL KIT PARTS  
PŮVODNÍ DÍLY STAVEBNICE

PHOTO-ETCHED PARTS  
LEPTANÉ DÍLY

PARTS TO BE REMOVED  
DÍLY K ODSTRANĚNÍ

FILL  
TMELIT

**step 1**

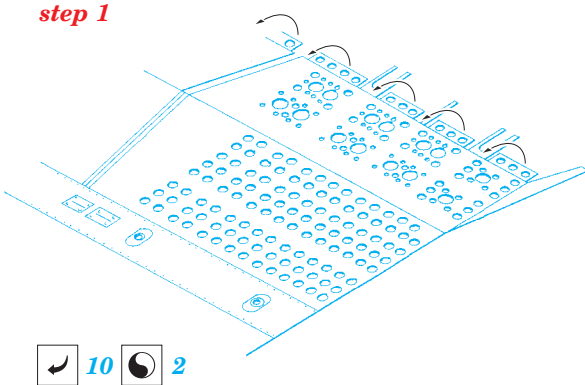

**step 2**

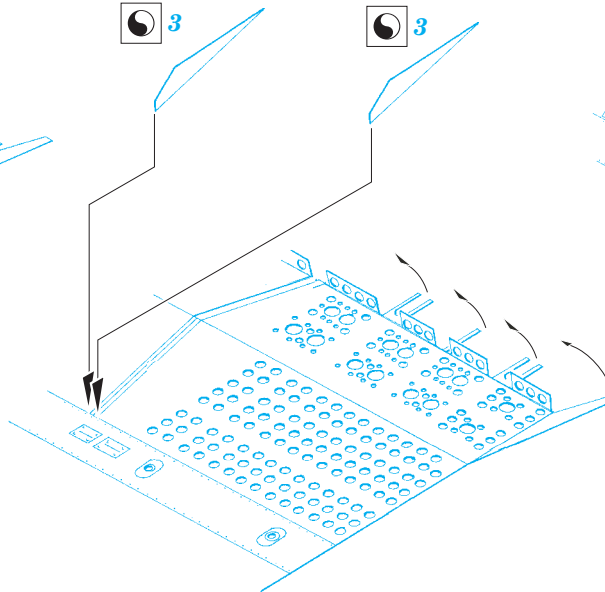

**step 3**

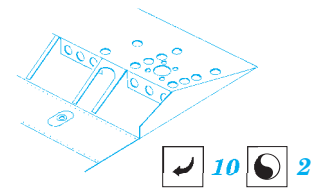

## REFERENCES:

SQUADRON / SIGNAL #54  
IN DETAIL / SCALE #52

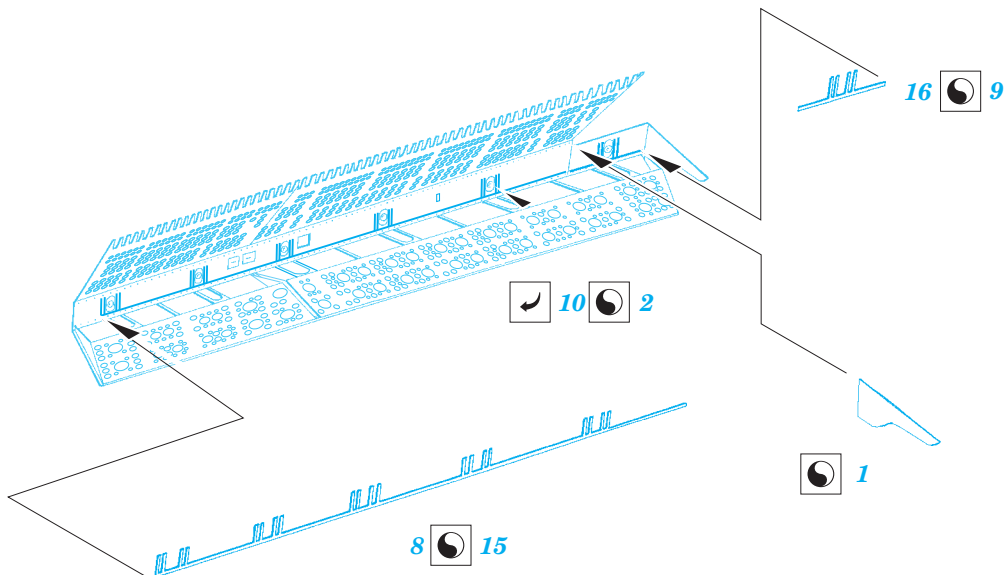

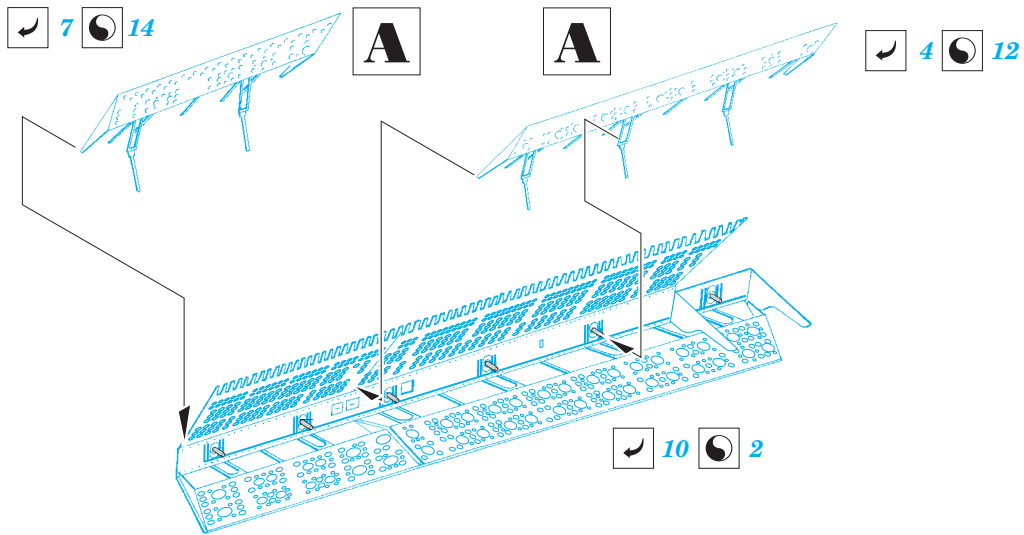
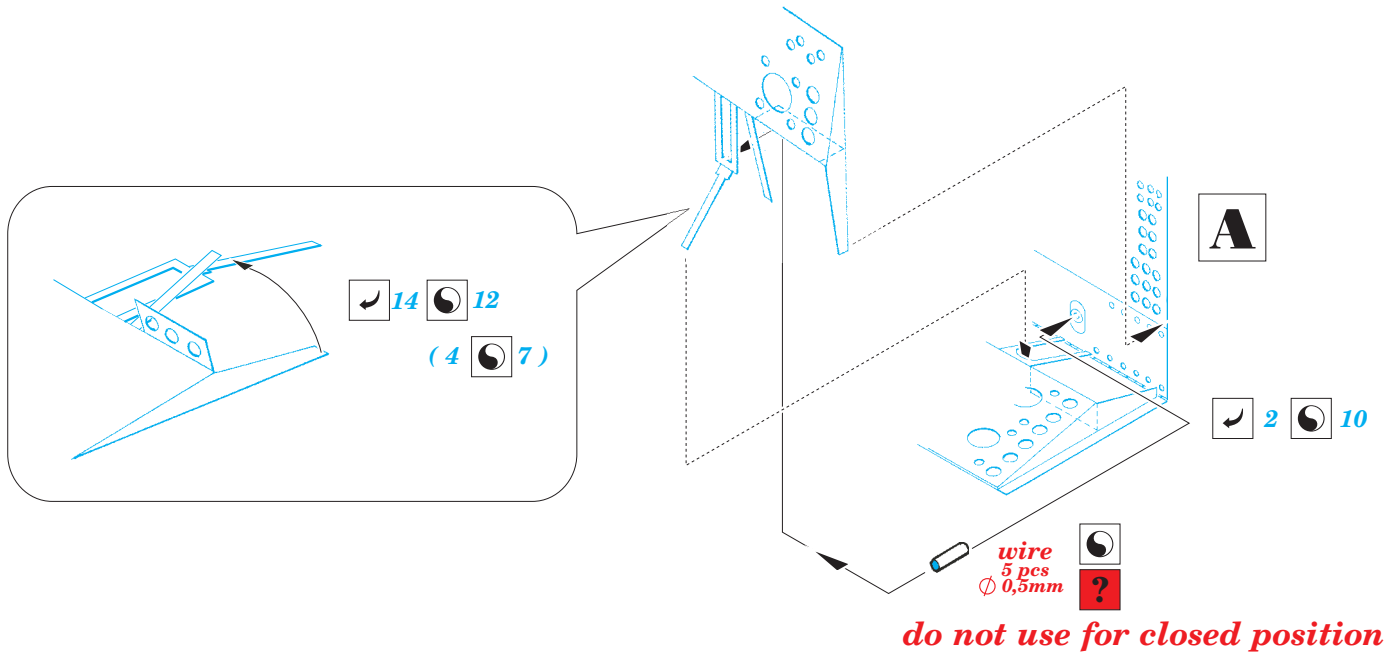

**do not use for closed position**

